



this is

 **HIPOWER™**  
your partner for power



# HIPOWER

- Full range of AC Generating sets.
- Complete range of control systems, switchgear and transfer switches.
- Remote monitoring.
- Extensive sales & service network.
- Extended warranty available.

All HIPOWER generators feature a robust construction with strict adherence to quality, while maintaining a minimal impact to the environment.

This unique design excels in all power generation applications, whether it be stand by, prime power or rental. HIPOWER has a generator to fit your needs.



this is



**HIPOWER**

EFFICIENT, RELIABLE & DEPENDABLE ON SITE POWER

Curved corners and terminations providing strength and durability to the equipment while presenting an attractive design.

Terminal box for AC power connection.

Stainless steel hardware and fasteners.

Rock wool sound insulation resistant to oil and heat (inside).

Single point lifting eye.

State of the art digital controls equipped with CAN BUS technology with an easy to use display and configurable parameters, alarms and protections.



Voltage selector switch 480/277 V, 208/120 V 3 phase and 240/120 V single phase available for rental versions.

Compact & durable design with large doors for easy access to perform scheduled maintenance.

## AVAILABLE CONTROL PANELS

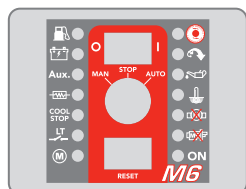

HIMOINSA M6  
ANALOG AUTO START

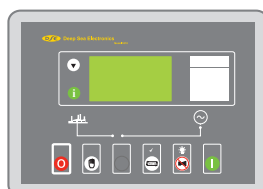

DEEP SEA 5310  
DIGITAL AUTO START

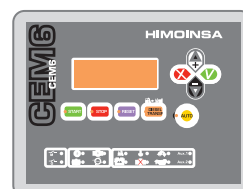

HIMOINSA CEM6  
ADVANCED DIGITAL AUTO START  
PARALLEL OPTIONAL

Top air discharge for better sound attenuation.

Hot & mobile components (exhaust, fan,...) and radiator guards

Standard fuel day tank, Extended run time and UL tank optional.

100% spill containment standard.



**60 Hz** 1,800 r.p.m.  
240/120V 1Ph.



Genset		Engine				Fuel Tank Gal.		Sound level (3)	Dimensions L x W x H (Inches)		Weight (Pounds)	
MODEL	kW (1)	Brand	Model	EPA (2)	Open Type	Enclos.	dB(A)	Open Type	Enclosed	Open Type	Enclos.	
HYW-9 M6	8.5	YANMAR	3TNV76	TIER 4	9.2	6.1	65	57.1 x 24.4 x 50.4	58.1 x 29.5 x 43.7	723	1347	
HYW-14 M6	13	YANMAR	3TNV88	" 4	9.2	6.1	60	57.1 x 24.4 x 50.4	58.1 x 29.5 x 43.7	853	1468	
HYW-20 M6	16	YANMAR	4TNV88	" 3	9.2	26.4	60	57.1 x 24.4 x 50.4	88.6 x 43.3 x 52.8	1003	2150	
HYW-35 M6	30	YANMAR	4TNV98	" 3	16.9	26.4	65	76.8 x 30.7 x 50.4	88.6 x 43.3 x 52.8	1332	2315	
HYW-45 M6	40	YANMAR	4TNV98T	" 3	24.8	26.4	63	76.8 x 30.7 x 50.4	88.6 x 43.3 x 52.8	1548	2491	
HPW-60 M6	62	PERKINS	I104D 44TG1	" 3	24.8	26.4	64	76.8 x 30.7 x 50.4	88.6 x 43.3 x 52.8	2083	2513	

**60 Hz** 1,800 r.p.m.  
208/120V & 480/277V 3Ph.

Genset		Engine				Fuel Tank Gal.		Sound level (3)	Dimensions L x W x H (Inches)		Weight (Pounds)	
MODEL	kW (1)	Brand	Model	EPA (2)	Open Type	Enclos.	dB(A)	Open Type	Enclosed	Open Type	Enclos.	
HYW-9 T6	8	YANMAR	3TNV76	TIER 4	9.2	6.1	65	57.1 x 24.4 x 50.4	58.1 x 29.5 x 43.7	677	1347	
HYW-14 T6	13	YANMAR	3TNV88	" 4	9.2	6.1	60	57.1 x 24.4 x 50.4	58.1 x 29.5 x 43.7	798	1468	
HYW-20 T6	17	YANMAR	4TNV88	" 3	9.2	26.4	60	57.1 x 24.4 x 50.4	88.6 x 43.3 x 52.8	875	2150	
HYW-25 T6	22	YANMAR	4TNV84T	" 3	16.9	26.4	58	66.9 x 24.4 x 50.4	88.6 x 43.3 x 52.8	917	2315	
HYW-35 T6	32	YANMAR	4TNV98	" 3	24.8	26.4	65	76.8 x 30.7 x 50.4	88.6 x 43.3 x 52.8	1202	2491	
HYW-45 T6	42	YANMAR	4TNV98T	" 3	24.8	26.4	63	76.8 x 30.7 x 50.4	88.6 x 43.3 x 52.8	1418	2513	
HPW-50 T6	48	PERKINS	I104D 44TG1	" 3	38.3	19.8	64	76.8 x 30.7 x 53.2	88.6 x 41.3 x 57.1	1940	2877	
HPW-65 T6	65	PERKINS	I104D E44TG1	" 3	38.3	46.2	65	90.6 x 30.7 x 53.8	108.3 x 43.3 x 59.1	2216	3186	
HPW-82 T6	81	PERKINS	I104D E44TAG1	" 3	38.3	46.2	67	90.6 x 30.7 x 53.8	108.3 x 43.3 x 59.1	2304	3406	
HPW-100 T6	100	PERKINS	I104D 44TG2	" 3	38.3	46.2	67	90.6 x 30.7 x 53.8	108.3 x 43.3 x 59.1	2568	3561	
HPW-145 T6	141	PERKINS	I106D E66TAG2	" 3	62.1	64.7	70	94.5 x 35.4 x 58.7	149.6 x 47.2 x 70.9	3715	5346	
HPW-155 T6	152	PERKINS	I106D E66TAG3	" 3	62.1	64.7	70	94.5 x 35.4 x 58.7	149.6 x 55.1 x 82.9	3781	5401	
HPW-180 T6	178	PERKINS	I106D E66TAG4	" 3	62.1	64.7	72	94.5 x 35.4 x 58.7	149.6 x 55.1 x 82.9	3858	5490	
HPW-465 T6	462	PERKINS	2506D E15TAG1	" 3	195.5	200.8	76	163.4 x 57.5 x 85.8	177.2 x 70.9 x 94.5	8345	12588	
HPW-515 T6	512	PERKINS	2506C E15TAG3	" 2	195.5	200.8	76	163.4 x 57.5 x 85.8	177.2 x 70.9 x 94.5	8576	12820	
HPW-555 T6	555	PERKINS	2506C E15TAG4	" 2	195.5	200.8	76	163.4 x 57.5 x 85.8	177.2 x 70.9 x 94.5	8863	13107	
HFW-90 T6	86	IVECO	NEF45 TM2X	" 3	54.2	46.2	67	80.7 x 29.5 x 58.2	108.3 x 43.3 x 59.1	2480	3682	
HFW-135 T6	127	IVECO	NEF67 TM1X	" 3	95.1	64.7	70	114.2 x 35.4 x 62.7	129.9 x 47.2 x 70.9	3307	4927	
HFW-150 T6	150	IVECO	NEF67 TE1X	" 3	95.1	64.7	70	114.2 x 35.4 x 62.7	129.9 x 47.2 x 70.9	3505	5126	
HFW-200 T6	185	IVECO	NEF67 TE1X	" 3	95.1	64.7	72	114.2 x 35.4 x 62.7	129.9 x 47.2 x 70.9	3638	5269	
HFW-250 T6	255	IVECO	C87 TE1D	" 3	117.6	117.6	72	123.0 x 41.7 x 85.0	149.6 x 55.1 x 82.9	6471	5368	
HFW-290 T6	288	IVECO	C10 TE1D	" 3	155.9	155.9	73	130.3 x 54.7 x 74.8	161.4 x 63.0 x 87.0	6228	9127	
HFW-350 T6	350	IVECO	C13 TE3X	" 3	155.9	155.9	75	130.3 x 54.7 x 74.8	161.4 x 63.0 x 87.0	6967	9866	

(1) Stand by Power rating in accordance with ISO 8528

(2) According to EPA 40 CFR part 89

(3) Sounds levels measured at 23 feet, 100% load

(4) Manufacturer reserves the right to change any of these specifications without prior notice.

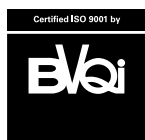
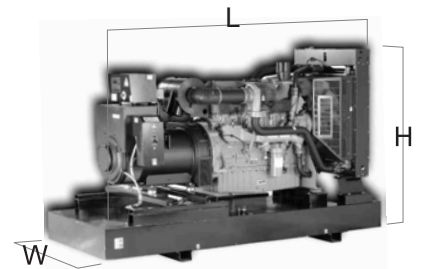
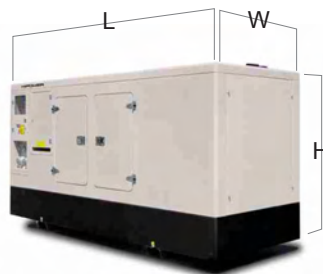

see our  
**2009**  
range

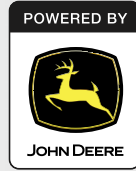

HIMOINSA POWER SYSTEMS, INC.  
16210 West 110th Street  
Lenexa, KS 66219-1312

Tel: 913-495-5557  
Fax: 913-495-5575

[www.hipowersystems.com](http://www.hipowersystems.com)

Call us (toll free) at: 1 866 710-2988



HIPOWER Generating sets  
engineered and design by HIMOINSA.

Generator for home use, construction, industrial,  
rental, event, prime and standby power.

**HIMOINSA**  
CORPORATION